



12 Lethbridge Road, Swindon, SN1 4BY

Guide price £269,995

Summary

Resides Swindon are delighted to be marketing this THREE BEDROOM terrace property set in the sought after location of OLD TOWN. This property has many benefits with SOME ORIGINAL FEATURES in keeping. The accommodation comprises, good size lounge/dining room with a fire basket custom made fireplace, kitchen/breakfast room has a newly fitted HOWDENS kitchen with custom-retro-formica-worktops. Bathroom with shower and WC and utility room. Three bedrooms to the first floor and subject to building regulations potential loft conversion for a fourth bedroom. To the rear is a low maintenance non overlooked garden. EARLY VIEWINGS RECOMMENDED TO AVOID DISAPPOINTMENT.





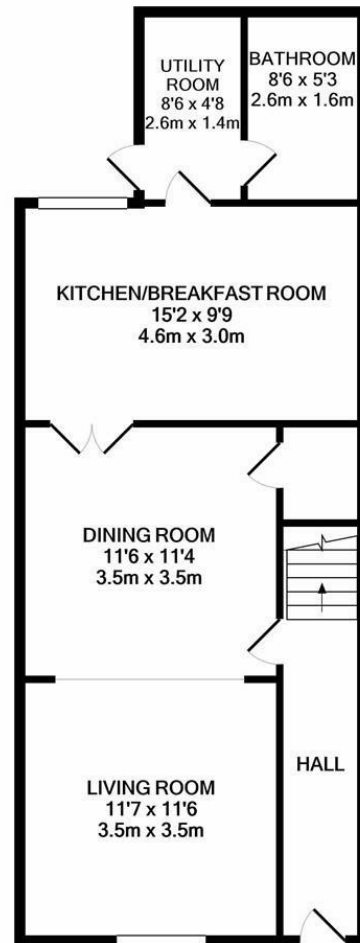

GROUND FLOOR
APPROX. FLOOR
AREA 580 SQ.FT.
(53.9 SQ.M.)

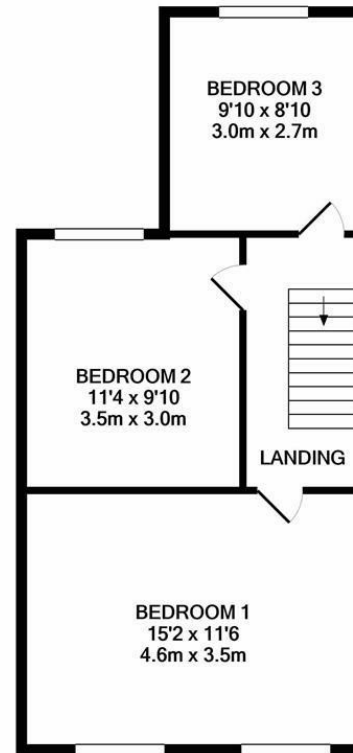

1ST FLOOR
APPROX. FLOOR
AREA 434 SQ.FT.
(40.3 SQ.M.)

TOTAL APPROX. FLOOR AREA 1014 SQ.FT. (94.2 SQ.M.)

Whilst every attempt has been made to ensure the accuracy of the floor plan contained here, measurements of doors, windows, rooms and any other items are approximate and no responsibility is taken for any error, omission, or mis-statement. This plan is for illustrative purposes only and should be used as such by any prospective purchaser. The services, systems and appliances shown have not been tested and no guarantee as to their operability or efficiency can be given

Made with Metropix ©2020

